

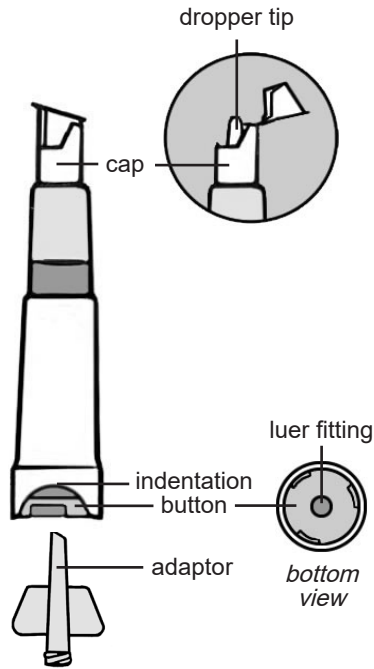

Weqas

WEQAS
 Unit 6, Parc Tŷ Glas, Llanishen,
 Cardiff, UK, CF14 5DU
 Tel: +44 (0) 2920 314750
 Fax: +44 (0) 2920 314760
 E-mail: office@weqas.com



For instructional video go to
www.eurotrol.com/acudrop2



ACU-Drop® II Instructions

Instruction A - Sampling with Dropper Tip

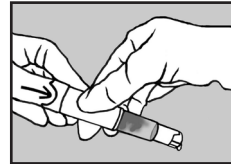

A1 - Press the button firmly until it is completely pushed in and level with the indentation.

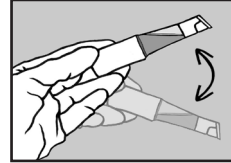

A2 - Gently rock and swirl at least 5 times to mix the content completely.

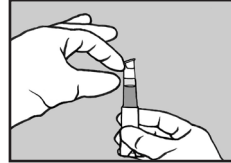

A3 - Hold the ACU-Drop II with cap facing up and flick the cap firmly several times to make sure that no liquid remains inside the dropper tip.

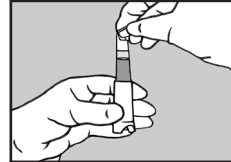

A4 - Open the flip cap very carefully by lifting the cap just a little bit to release the pressure.

-Only with first time use-



A5 - The first 2 drops should be dispensed and discarded.

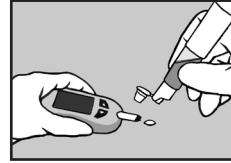

A6 - The ACU-Drop II is now ready to use to apply a sample drop for testing. Samples can be decanted into an empty sample cup/tube before presenting to a device.

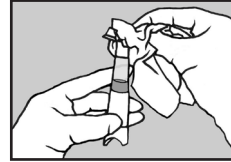

A7 - After each use, be sure to wipe the dropper tip and inside of cap to keep them clean.

Instruction B - Sampling with Syringe

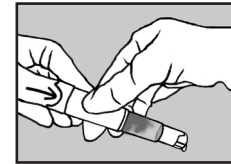

B1 - Press the button firmly until it is completely pushed in and level with the indentation.

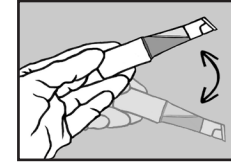

B2 - Gently rock and swirl at least 5 times to mix the content completely. Once mixed, open the flip cap just a little bit, very carefully, to release any pressure.

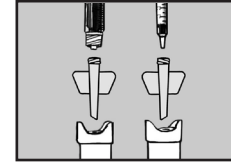

B3 - Twist the adaptor onto the tip of either a luer lock or standard syringe.

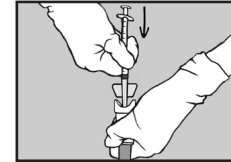

B4 - Hold the ACU-Drop II with cap facing down and flick the bottom firmly several times to be sure that all the liquid settles. Push the adaptor tip attached to the syringe firmly into the luer fitting on the button of the ACU-Drop II.

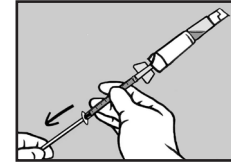

B5 - Hold the ACU-Drop II with cap facing up and, using both hands on the syringe, withdraw the contents.

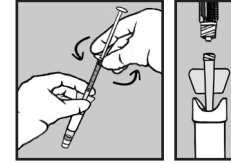

B6 - Hold the adaptor with the ACU-Drop II cap facing down and carefully unscrew the syringe, leaving the adaptor in the button of the ACU-Drop II.



B7 - Use the syringe to deliver your sample. **After usage, reattach the ACU-Drop II to the syringe to reuse or discard.**

Please note: Samples should be stored at 2-8°C. Samples are stable for 15 minutes after reconstituting.

Minimum 15 minutes to bring samples up to room temperature before reconstitution, but not more than 60 minutes (do not put vials back into refrigerator once brought to room temperature).

Please follow manufacturers' instructions regarding mode of analysis for introducing the EQA samples.
 Please state the mode of analysis on return sheet or comments box if reporting results online.